

Olympia Medical Center

Floor 1

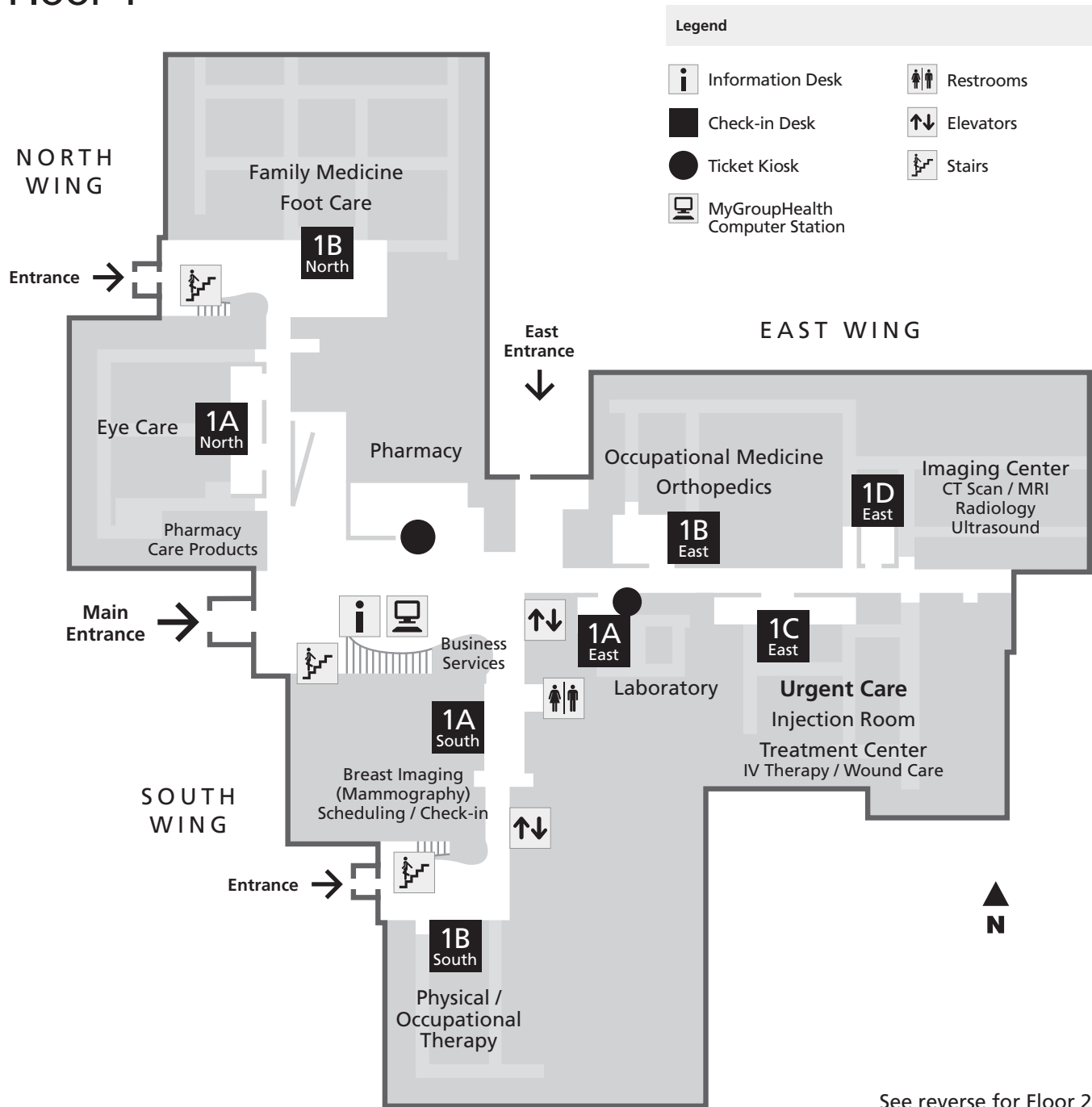

Department	Wing	Check-in
Breast Imaging Scheduling / Check-in	South	1A
Business Services	Main Lobby	-
Eye Care Contact Lens Services Optical Shop Optometry	North	1A
Family Medicine	North	1B
Foot Care	North	1B
Imaging Center CT Scan MRI Radiology Ultrasound	East	1D
Information	Main Lobby	-
Injection Room	East	1C
Laboratory	East	1A Ticket Kiosk
Occupational Medicine	East	1B
Orthopedics	East	1B
Pharmacy	Main Lobby	Ticket Kiosk
Physical / Occupational Therapy	South	1B
Treatment Center IV Therapy Wound Care	East	1C
Urgent Care	East	1C

See reverse for Floor 2

Olympia Medical Center

Floor 2



Department	Wing	Check-in
Administration	North	-
Allergy	North	2B
Audiology / Hear Center	North	2A
Behavioral Health Services	East	2C
Conference Rooms	North	-
Dermatology	North	2B
Echocardiology	East	2D
Family Medicine	North	2C
Family Medicine	South	2C
General Surgery	South	2B
Gynecology	East	2D
Hematology	East	2B
Infusion Center	East	2B
Internal Medicine	South	2A
Midwifery	East	2D
Nutrition Services	North	2B
Obstetrics	East	2D
Oncology	East	2B
Otolaryngology	North	2B
Pediatrics / Teen Health	East	2A
Speech, Language & Learning Services	North	2B
Urology	East	2D
Vascular Surgery	South	2B
Visiting Specialties Cardiology Nephrology	South	2A

See reverse for Floor 1